

General Duty 9,000 lb. - 10,000 lb.  
**10k TORFLEX**  
 RUBBER TORSION SUSPENSION AXLES  
 Heavy Duty 9,000 lb. - 10,000 lb.



## SPECIFICATIONS

**Suspension:** Features an independent suspension cushioned with rubber, providing a smooth, quiet ride with no transfer of road shock from one wheel to the other. (No springs required)

**Brake Options:** (Forward Self Adjusting)

- #10K GD • 12 1/4 x 3 3/8" Electric  
 • 12 1/4 x 3 3/8" Hydraulic: Duo-Servo, Standard; (Optional Uni-Servo) with or without parking feature  
 • ABS Equipped Option for Hydraulic Brakes
- #10K HD • 12 1/4 x 4" Electric  
 • 12 1/4 x 4" Hydraulic: Duo-Servo, Standard; (Optional Uni-Servo) with or without parking feature  
 • ABS Equipped Option for Hydraulic Brakes

**Bolt Pattern Options:**

- #10K GD & HD • 8 on 6 1/2"

**Spindles:**

- #10K GD • 387A Inner, 25580 Outer Bearings  
 #10K HD • 395S Inner, 387A Outer Bearings

**Lubrication:**

- #10K GD & HD • Oil Bath

**Wheel Assemblies:** See Section E

### #10K General Duty Torflex Axle Assemblies

Axle Type	ABS Equipped,	
	8 on 6 1/2"	8 on 6 1/2"
Electric	10GDTF-865E	N/A
Duo-Servo		
Hydraulic	10GDTF-865HY	10GDTF-865HABS

### #10K Heavy Duty Torflex Axle Assemblies

Axle Type	ABS Equipped	
	8 on 6 1/2"	8 on 6 1/2"
Electric	10HDTF-865E	N/A
Duo-Servo		
Hydraulic	10HDTF-865HY	10HDTF-865HABS

### Replacement Parts:

**Hub/Drums:** 10K GD & HD

See Page B-29, B-30

**Brakes:**

10K GD - See Page C-16 (Electric),  
 Page C-30 (Hydraulic)

10K HD - See page C-18 (Electric),  
 Page C-31 (Hydraulic)

### 10K Torflex Mounting Kit & Axle Options

Part No.	Ref No.	Description
XTRA-HF-10KTF	064965	EXTRA CHARGE (PER AXLE) FOR AXLES OVER 80" HUB FACE
10KTF-HYD-PARK	064970	HYDRAULIC BRAKES W/ PARK, ADD TO 10K TORFLEX HYDRAULIC BRAKE AXLE PRICE
10KTF-PWC	064975	EXTRA CHARGE FOR 10K TORFLEX ELECTRIC W/ PWC OPTION INSTALLED
AP169	064900	WELD-ON MOUNTING KIT FOR 10K TORFLEX AXLE

For information on ordering and installing Torflex axles, see pages A-26 thru A-28.  
 For specific ordering information, please call your nearest Branch.

**10K TORFLEX SPECIFICATIONS**  
**MOUNTING DETAILS**

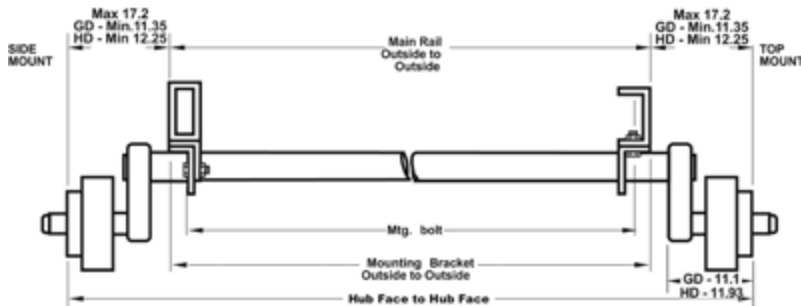

**Difference between hub face and mounting brackets**

**Minimum**

10K GD - 22.70" (11.35" per side)  
10K HD - 24.50" (12.25" per side)

**Maximum**

10K GD & HD - 34.40" (17.2 per side)

Note: Minimums are based on manufacturing tolerances only. Some tire and wheel combinations may create interference.



**Full Load Dimensions**

Dimensions are for low profile, top mount only. High profile brackets are .75" higher. Side mount is .31" higher. Allow 3" bump clearance from full load.

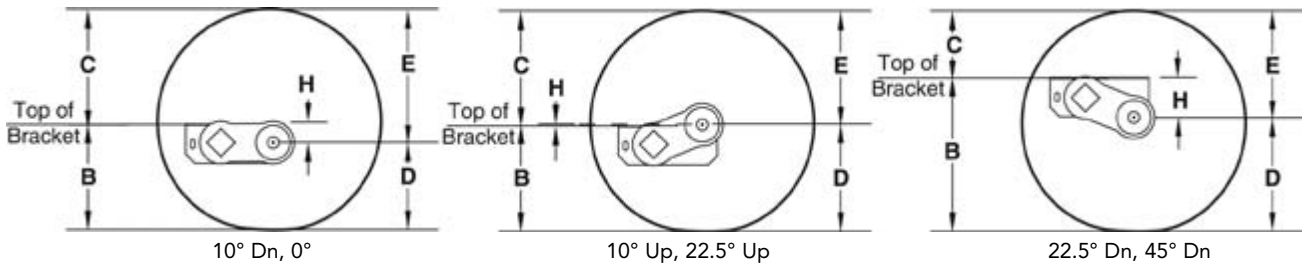

H = Center Line of spindle to top of bracket, B = Top of bracket to ground, C = Top of bracket to top of tire, D = Center Line of spindle to ground, E = Center Line of spindle to top of tire.

**Start Angle**

Tire	45° Down			22.5° Down			10° Down			0°			10° Up			22.5° Up			D	E
	H	B	C	H	B	C	H	B	C	H	B	C	H	B	C	H	B	C		
10R17.5 HC	5.2	20.2	13.4	2.9	17.9	15.7	1.6	16.6	17.0	0.6	15.6	18.0	-0.3	14.6	18.9	-1.3	13.6	19.9	15.6	18.0
215/75R 17.5	5.2	18.6	10.8	2.9	16.3	13.1	1.6	15.0	14.4	0.6	14.0	15.4	-0.3	13.0	16.3	-1.3	12.0	17.3	14.0	15.3
12-16.5 LT	5.2	19.5	11.3	2.9	17.2	13.6	1.6	15.9	14.9	0.6	14.9	15.9	-0.3	13.9	16.8	-1.3	12.9	17.8	14.9	15.8
9.50-16.5 LT	5.2	18.7	10.6	2.9	16.4	12.9	1.6	15.1	14.2	0.6	14.1	15.2	-0.3	13.1	16.1	-1.3	12.1	17.1	14.1	15.2
9R 17.5 HC	5.2	20.0	12.5	2.9	17.7	14.8	1.6	16.4	16.1	0.6	15.4	17.1	-0.3	14.4	18.0	-1.3	13.4	19.0	15.4	17.1

**ARTICULATION DIMENSIONS**

ALLOW 3" BUMP CLEARANCE FROM FULL LOAD.

Positive numbers indicate spindle is below the top of the bracket, negative numbers are above.

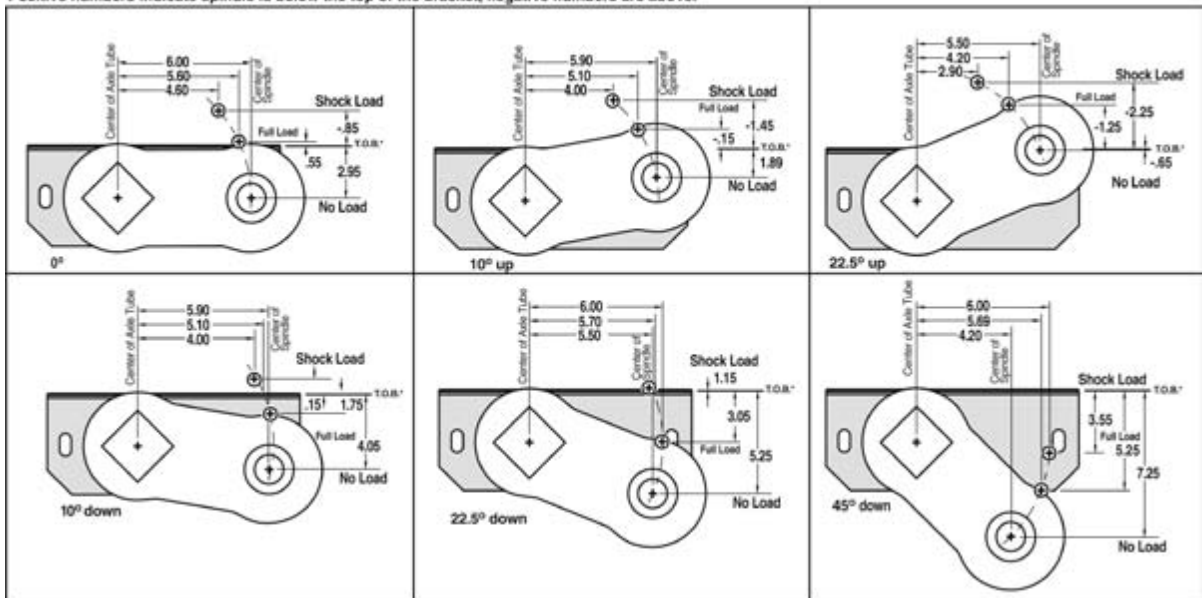

\* TOP OF BRACKET